

- ROAD NAMES NOT SHOWN
- 1. DOBNEY RD.
 - 2. HENRY TAYLOR RD.
 - 3. NEW JOHN RD.
 - 4. R. LEWIS RD.
 - 5. TALL NEELY RD.
 - 6. MARGARET PENNINGTON RD.
 - 7. JAMES LITTLE RD.
 - 8. TAYLOR LN.
 - 9. MINOR DR.
 - 10. JOHN RD.
 - 11. JOHN WAY RD.
 - 12. ABE SMITH RD.
 - 13. N. PLEASANT HILL RD.
 - 14. LAWRENCE CO. LINE RD.
 - 15. JOHNSON & GRAVES RD.
 - 16. SUSAN RD.
 - 17. JIMMY BROWN RD.
 - 18. CALVARY CHURCH RD.
 - 19. J. J. HERRINGTON RD.
 - 20. LARRY WALKER RD.
 - 21. MICHAEL TOSTON RD.
 - 22. GARDNER RD.
 - 23. OLD HUBBARD TOWN RD.
 - 24. D. P. BROWN RD.
 - 25. W. WILLIAMSON RD.
 - 26. LITTLE ROCK WELCH RD.
 - 27. SHERLEY MADOCK RD.
 - 28. N. HARRISON RD.
 - 29. JOHN H. RD.
 - 30. GUTMAN MADRID RD.
 - 31. JAMES MADRID RD.
 - 32. S. W. WALKER RD.
 - 33. S. W. WALKER RD.
 - 34. S. W. WALKER RD.
 - 35. S. W. WALKER RD.
 - 36. S. W. WALKER RD.
 - 37. S. W. WALKER RD.
 - 38. S. W. WALKER RD.
 - 39. S. W. WALKER RD.
 - 40. S. W. WALKER RD.
 - 41. S. W. WALKER RD.
 - 42. S. W. WALKER RD.
 - 43. S. W. WALKER RD.
 - 44. S. W. WALKER RD.
 - 45. S. W. WALKER RD.
 - 46. S. W. WALKER RD.
 - 47. S. W. WALKER RD.
 - 48. S. W. WALKER RD.
 - 49. S. W. WALKER RD.
 - 50. S. W. WALKER RD.
 - 51. S. W. WALKER RD.
 - 52. S. W. WALKER RD.
 - 53. S. W. WALKER RD.
 - 54. S. W. WALKER RD.
 - 55. S. W. WALKER RD.
 - 56. S. W. WALKER RD.
 - 57. S. W. WALKER RD.
 - 58. S. W. WALKER RD.
 - 59. S. W. WALKER RD.
 - 60. S. W. WALKER RD.
 - 61. S. W. WALKER RD.
 - 62. S. W. WALKER RD.
 - 63. S. W. WALKER RD.
 - 64. S. W. WALKER RD.
 - 65. S. W. WALKER RD.
 - 66. S. W. WALKER RD.
 - 67. S. W. WALKER RD.
 - 68. S. W. WALKER RD.
 - 69. S. W. WALKER RD.
 - 70. S. W. WALKER RD.
 - 71. S. W. WALKER RD.
 - 72. S. W. WALKER RD.
 - 73. S. W. WALKER RD.
 - 74. S. W. WALKER RD.
 - 75. S. W. WALKER RD.
 - 76. S. W. WALKER RD.
 - 77. S. W. WALKER RD.
 - 78. S. W. WALKER RD.
 - 79. S. W. WALKER RD.
 - 80. S. W. WALKER RD.
 - 81. S. W. WALKER RD.
 - 82. S. W. WALKER RD.
 - 83. S. W. WALKER RD.
 - 84. S. W. WALKER RD.
 - 85. S. W. WALKER RD.
 - 86. S. W. WALKER RD.
 - 87. S. W. WALKER RD.
 - 88. S. W. WALKER RD.
 - 89. S. W. WALKER RD.
 - 90. S. W. WALKER RD.
 - 91. S. W. WALKER RD.
 - 92. S. W. WALKER RD.
 - 93. S. W. WALKER RD.
 - 94. S. W. WALKER RD.
 - 95. S. W. WALKER RD.
 - 96. S. W. WALKER RD.
 - 97. S. W. WALKER RD.
 - 98. S. W. WALKER RD.
 - 99. S. W. WALKER RD.
 - 100. S. W. WALKER RD.

LEGEND

ROADS AND ROADWAY FEATURES

- UNIMPROVED ROAD
- GRAVEL
- PAVED ROAD
- UNPAVED HIGHWAY
- DIVIDED HIGHWAY
- OVERPASS
- INTERSTATE SYSTEM
- CITY STREETS

HIGHWAY BRIDGES

- BRIDGE 50 FEET AND OVER
- DRAWBRIDGE
- FERRY (FREE OR TOL)
- HIGHWAY GRADE SEPARATION
- HIGHWAY INTERCHANGE

ROAD SYSTEM DESIGNATION

- INTERSTATE NUMBERED
- U.S. NUMBERED
- STATE NUMBERED

RAILROADS

- RAILROAD STATION
- GRADE CROSSING
- RAILROAD ABOVE
- RAILROAD BELOW

AIRPORTS

- MILITARY AIRPORT
- AIRPORT LIMITED FACILITIES
- LANDING AREA OR STRIP
- INCLOSURE PRIVATE AIR FIELD
- AIRPORT COMPLETE FACILITIES
- AIRWAY LIGHT BEACON

DRAINAGE AND NATURAL FEATURES

- NARROW STREAM
- DRAINAGE DITCH
- LAKES AND RESERVOIRS
- RAILROAD AND LAND
- MARSH OR SWAMP LAND

BOUNDARIES

- STATE BOUNDARY
- COUNTY BOUNDARY
- BEAT LINE
- CONGRESSIONAL TOWNSHIP
- SECTION LINE
- NATIONAL OR STATE FOREST
- RESERVATION, PARKS ETC.
- URBAN AREA CONTRACT
- INCORPORATED PLACES
- UNINCORPORATED DELIMITED AREAS

NAVIGATION

- DOCK, PER OR LANDING
- LEVEL OR DUNE
- LEVEE OR DUNE WITH ROAD

CITY AND VILLAGE CENTERS

- COUNTY SEAT
- OTHER CITIES AND VILLAGES

MISCELLANEOUS

- TRIANGULATION STATION
- BENCH MARK WITH ELEVATION

PUBLIC SERVICE FACILITIES

- OBSERVATION OR LOOKOUT TOWER
- HIGHWAY GARAGE
- POST OFFICE
- POWER PLANT
- WEIGHT STATION
- HOSPITAL
- SEWAGE DISPOSAL PLANT
- COMMUNITY CENTER OR TOWNHALL
- NATIONAL PARK GARAGE
- FIRE STATION
- PUBLIC LIBRARY
- SANITARY LAND FILL
- CORRECTIONAL INSTITUTION
- POLICE STATION
- GRAVEL PIT
- REST AREA

CONSERVATION AND RECREATION

- MOTEL OR HOTEL
- CAMP OR LODGE
- HISTORIC OR SCENIC SITE
- FAIR GROUNDS OR RACE COURSE
- SMALL PARK
- GOLF COURSE OR COUNTRY CLUB

CHURCHES AND CEMETERIES

- CHURCH
- CEMETERY
- CHURCH WITH CEMETERY ADJACENT

MISCELLANEOUS STRUCTURES

- ARMORY
- FORT, ARMY CAMP

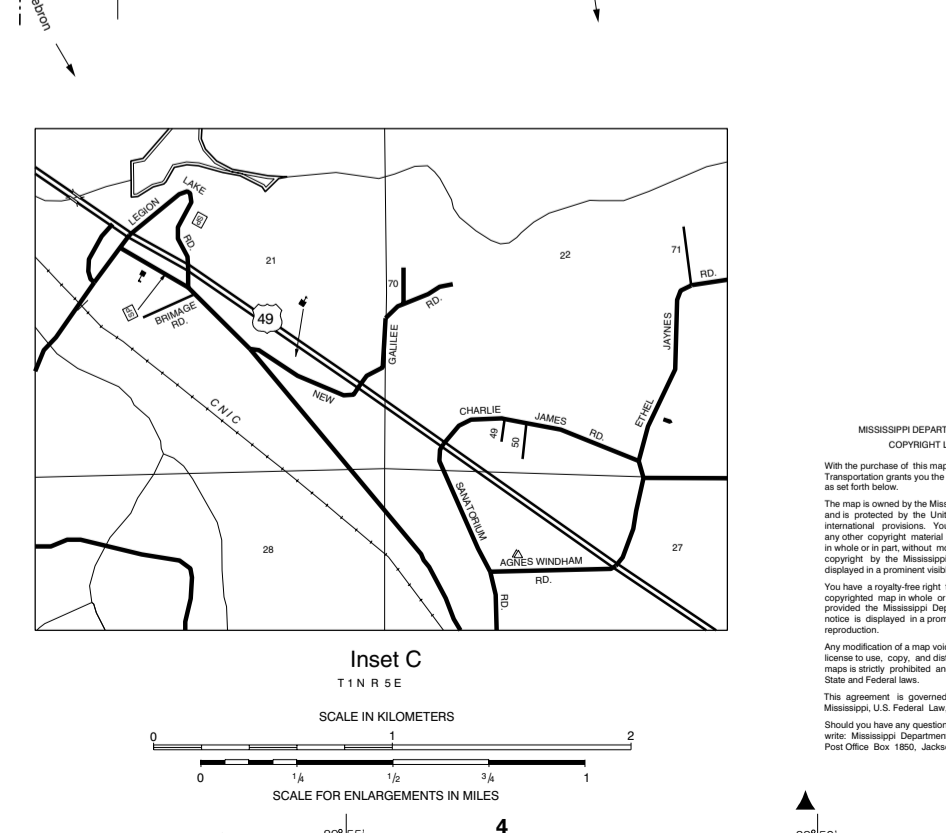
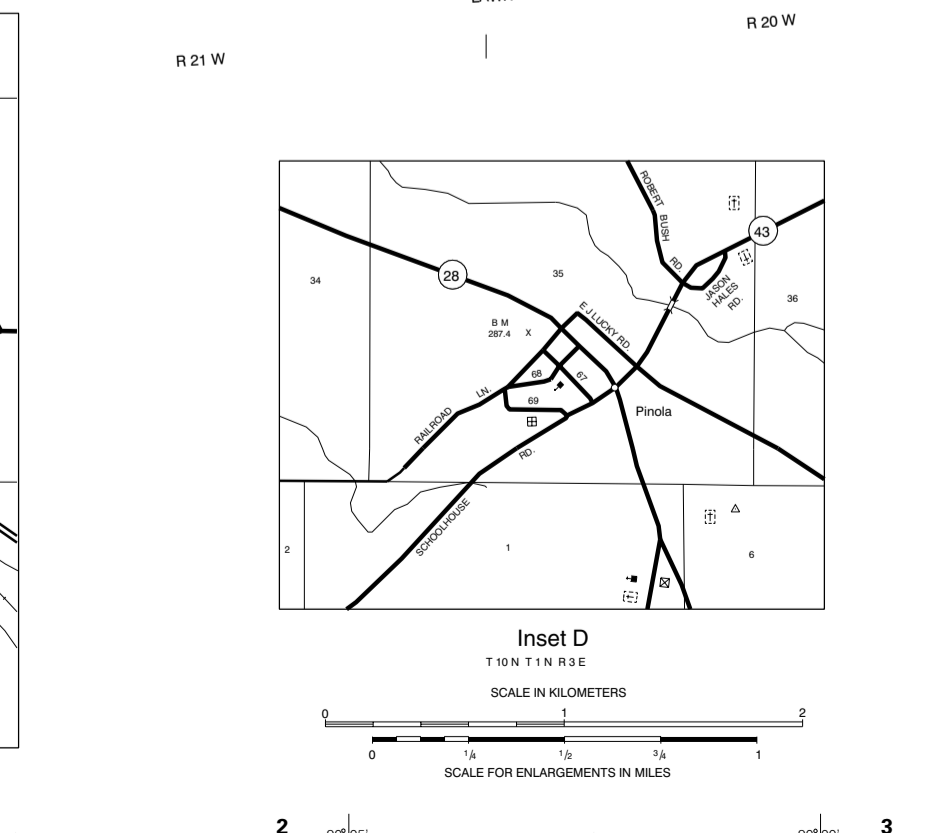
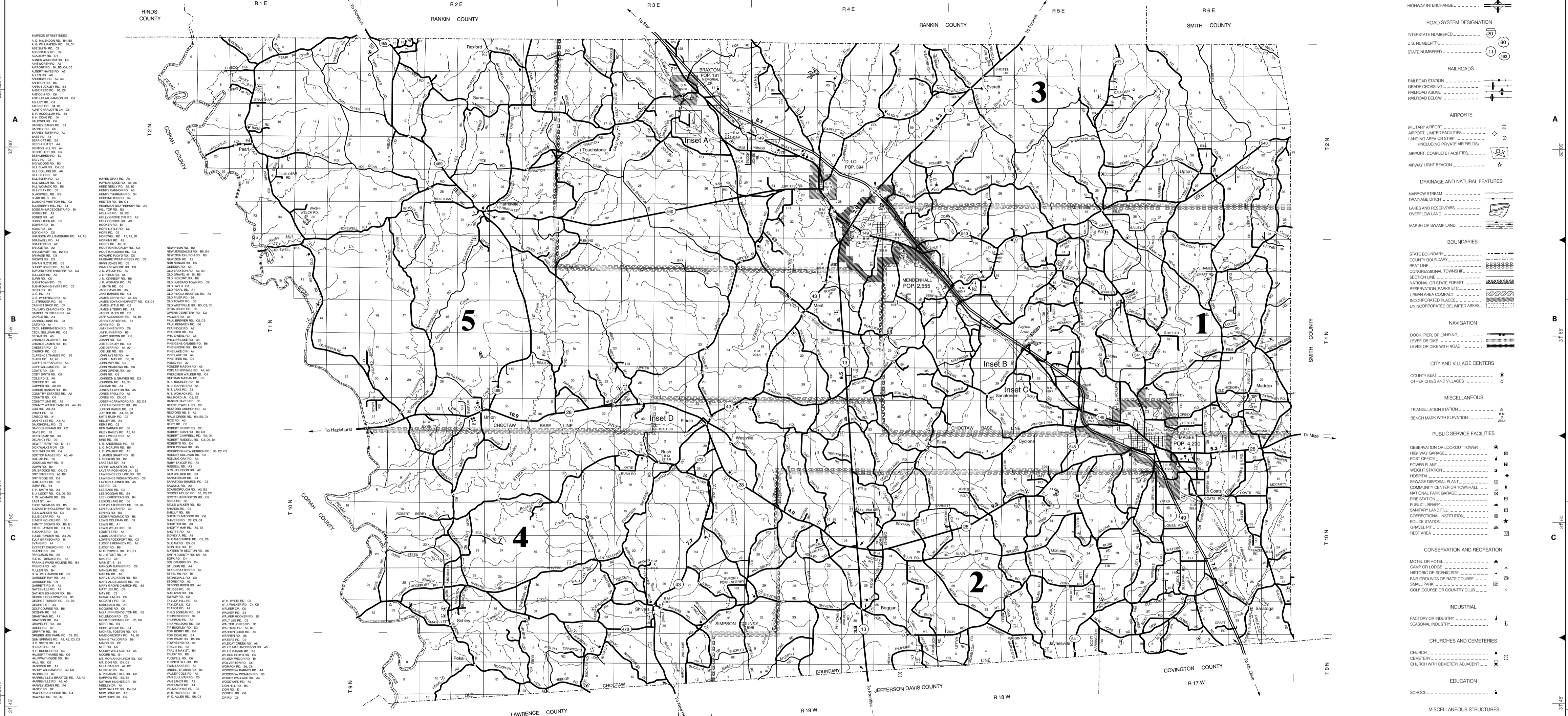

GENERAL HIGHWAY MAP

SIMPSON COUNTY

MISSISSIPPI
© 1998

MISSISSIPPI DEPARTMENT OF TRANSPORTATION
PLANNING DIVISION
IN COOPERATION WITH THE
U.S. DEPARTMENT OF TRANSPORTATION
FEDERAL HIGHWAY ADMINISTRATION

TRANSVERSE MERCATOR PROJECTION,
STATE PLANE COORDINATE SYSTEM 1983

MISSISSIPPI DEPARTMENT OF TRANSPORTATION
COPYRIGHT LICENSE AGREEMENT

With the purchase of this map, the Mississippi Department of Transportation grants you the right to use the copyrighted map as an individual user.

This map is owned by the Mississippi Department of Transportation and is provided to the general public for informational and non-commercial purposes. You are required to treat this map as a non-commercial product. You are prohibited from copying, reproducing, or distributing this map in any form or by any means, including electronic, mechanical, photocopying, recording, or by any information storage and retrieval system, without the prior written permission of the Mississippi Department of Transportation.

You have a non-exclusive right to reproduce and distribute the copyrighted map in whole or in part, without modification, provided the Mississippi Department of Transportation copyright notice is included in the printed version of the map. You may not use the map in any way that would constitute a commercial or promotional activity.

This agreement is governed by the laws of the State of Mississippi, U.S. Federal Law, and U.S. International Treaties.

Please refer to the conditions concerning the agreement, attached under Mississippi Department of Transportation, Planning Division, First Office 1000 Jackson, Mississippi 39201-1000.

DATA SOURCES

- 1991 ASCS AERIAL PHOTOS
- 1987 USGS DLG
- 1995 MDT FIELD INVENTORY
- 2000 POPULATION 27,639
- 1970 BEAT LINES

SCALE IN KILOMETERS

SCALE IN MILES

THIS MAP WAS COMPUTER GENERATED